



THE AMERICAN SOCIETY OF PLUMBING ENGINEERS

ASPENEWS

1973 - THE BOSTON CHAPTER - 2009

A.S.P.E. - P.O. Box 111, East Walpole, MA 02032 - Vol. 36, Issue 5

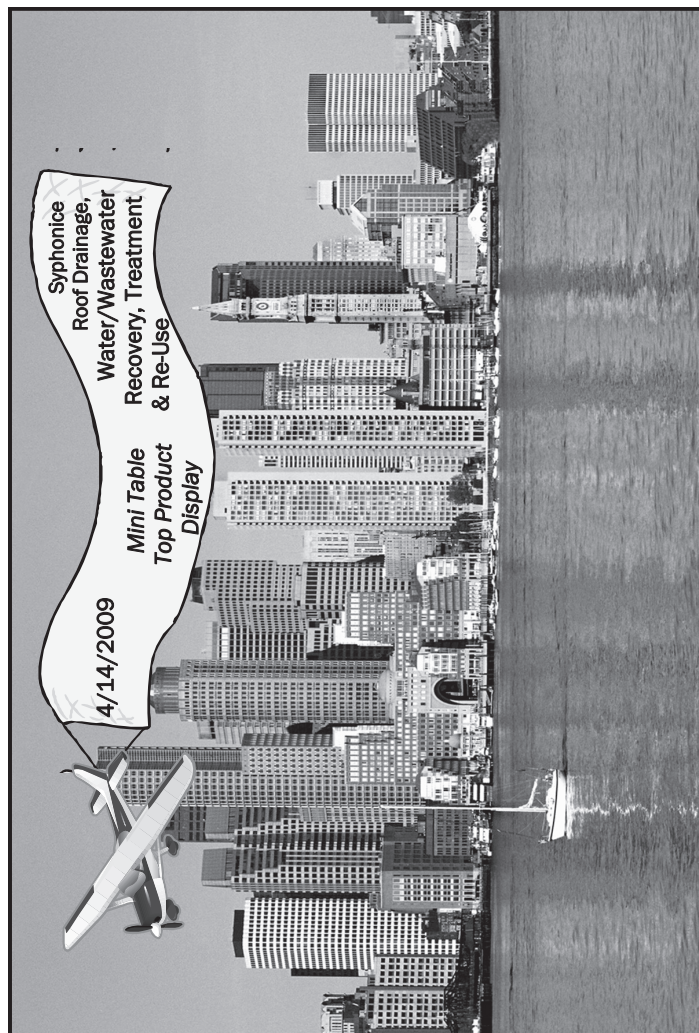

WHAT'S IN THIS ISSUE

Presidents Report	2
Membership Report	2
Technical Report	3
Legislative Report	Insert
Ask The Architects	5
Delegate Report	6
Calendar	Insert
Mini Table-Top Product Display Info	Insert

Society email aspehq@aol.com

Society Website www.aspe.com

Boston Chapter Website www.aspebos.org

Next Meeting

Tuesday, January 13th, 2009

The Lantana, Randolph, MA

MAIN PROGRAM

Resume & Interview Workshop

GUEST SPEAKER

Lisa Trafocante

PROGRAM SCHEDULE

Social Hour	5:00 – 6:00
Dinner	6:00 – 7:00
Chapter Business	6:45 – 7:00
Speaker / Technical Session	7:00 – 8:30

MENU

Italian Wedding Soup, Stuffed Pork
& Peach Melba

MEETING RESERVATIONS

\$30.00 Reservation / \$40.00 W/O Reservation

"FREE" with sign up of New Member

\$15.00 off if you bring a Guest

Please reserve by **FRIDAY, January 9, 2009**

Contact Cathy @ W.P. Haney, (508) 238 – 2030

**Where Quality and Professionalism
are an every day standard!**

Chapters are not authorized to speak for the Society

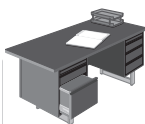

President's Report

Ladies and gentlemen first let me wish you all Happy Holidays. The board has been hard at work since we got back from the convention. First, the board has started a sub committee, led by Rich Dean, to update and improve the Boston Chapter website. Hopefully by mid 09 the website will be a more useful tool for both the members and guests that visit it. Secondly, we are in negotiations with a company to provide us the ability to do blast emails which will help in a couple of ways. We can remind people about up coming events and start to send the monthly newsletter in electronic form.

At the convention they had a 8 hour seminar on Revit. The board has received all the information from the company that put it on and we will be looking into getting a seminar together, which I promised the membership. This way everyone can benefit from being a member of ASPE and the Boston Chapter.

I want all the members to know I have changed companies my new email is fneth@eypae.com

By Frederick Neth, CPD, President, Boston Chapter ASPE

2009 Boston Chapter Product Show and Seminars

The Product Show will be in November of 2009.
Frank Teebagy, Chair, Paul Taylor Deputy Chair, and
Nancy Bonetti, Vendor Chair are forming the committee.

The Committee will be meeting in January.
All interested members should contact
Frank at 617-494-9090, Paul at 508-230-0260 or Nancy at 781389-2060.



Membership News

New Members

It is my pleasure to welcome the following new member to the Boston Chapter:

Ron Belling	Burt Process Equipment	West Brookfield, MA	Affiliate
Dorian Alba	Zade Company	Boston, MA	Full

As of October 1st, the Boston Chapter is the second largest chapter with a total of 357 members. Our membership is comprised of 184 Full members, 45 Associate members, 83 Affiliate members, 5 Government members, 28 Special members, 4 Life members, and 7 Retired members.

As is the case every month, I have received our updated membership roster from Society. This month, there are 15 members who are past due in sending their membership dues payment into Society. Maybe you've changed addresses this past year and haven't received your membership renewal notice. If so, let me know so I can forward your new contact information on to Society.

Whatever the case, I just want to make the following members aware that they are in jeopardy of being dropped from the membership roster by Society. Those on the list are DeBonis, Conoby, Dube, Cannizzaro, Doyle, O'Neill, Faulkner, Chaviano, Petrie, Coduri, Wong, Ecklund, Kealty, Holway and Moffatt. To those who have already sent in your payment, thank you. For the remainder, please consider this as a gentle reminder to do so. If you need another dues invoice, please call me and I'll arrange for one to be sent out to you. If you need to update your contact information, please let me know. I'd appreciate it.

By John Callahan, CPD, V.P. Memb., Boston Chapter ASPE

President

Fredrick S. Neth, CPD
Cosentini Associates
Tel: (617) - 494 - 9090 xt 327
Fax: (617) - 494 - 9292
e-mail: fneth@eypae.com

V. P. Technical

James Polando, PE, CPD
WSP Flack + Kurtz
Tel: (617) - 210 - 1639
Fax: (617) - 210 - 1800
e-mail: James.Polando@wspfk.com32

V. P. Legislative

Manuel B. Garcia, PE, CPD
Tel / Fax: (774) - 202 - 7677
e-mail: mgarcia43@comcast.net

V. P. Membership

John Callahan
J. H. Pokorny Associates
Tel: (781) - 762 - 2661
Fax: (781) - 762 - 5949
e-mail: johnc@jhpokorny.net

Treasurer

Richard Pokorny
J. H. Pokorny Associates
Tel: (781) - 762 - 2661
Fax: (781) - 762 - 5949
e-mail: richp@jhpokorny.net

Administrative Secretary

Paul Galvin
George Fischer Sloane, Inc.
Tel: (501) - 658 - 1115
e-mail: paul.galvin@georgfischer.com

Corresponding Secretary

Patrick J. Haney
W. P. Haney Company
Tel: (508) - 238 - 2030
Fax: (508) - 238 - 8353
e-mail: phaney656@aol.com

ASPENEWS Editor

Dawn Pokorny
Tel: (508) - 520 - 0133
Fax: (781) - 762 - 5949
e-mail: dawnp@jhpokorny.net

Education Chairman

Al Marzullo PE, CPD
The Marzullo Group
Tel: (617) - 331 - 8714
Fax: (617) - 591 - 2086
e-mail: al@marzullo.com

Website Chairman

Denis J. Perreault
Arcane Corporation
Tel: (508) - 369 - 4717
e-mail: denis@arcanecorp.com

Board of Governors

Chairman - Al Marzullo PE, CPD

Members

Joseph A. Vela, Sr., CPD
William F. Hughes, CPD

Affiliate Liaison

Tom J. Farrell
Tel: (781) - 344 - 1988



Technical Report

Solar Water Heating - January 13th, 2009

This month we have made some changes in the programming to present a topic that is most timely for our attendees, and is responsive to the current employment status of many of our members. Sadly this could be important to an ever growing number of our members as the unemployment rate in our business seems to be growing at an alarming rate.

We have entreated Lisa Traficante to speak to us about how we should assemble a resume, what employers look for when reviewing and screening resumes for potential interviews, how to appropriately present, not only your resume, or CV, but how to present yourself during a phone screening, an interview, a post-interview session, and discussions with HR representatives of a potential new employer.

So, if you are employed and are thinking of moving, or if you are one of the unlucky individuals that finds yourself looking for your next position, this is a great opportunity to learn from a recruiting professional, what the employers are looking for in a likely candidate to fill the shrinking number of openings in our field.

Please don't be concerned about showing interest in this topic in front of your peers. This is the real world and we are all looking to remain employed, not over-sell ourselves, but present ourselves and our experience in the best possible way to secure that next position.

Bring your questions, ask about how to best network within our profession to understand where the opportunities are, and who may be out there that could help us find that next job. Also, what resources are available to us in these trying economic times.

For the record, Lisa is a recruiter, specializing in Architectural and Engineering firms in the greater Boston area. Her company focuses on securing positions for employers, and her fees are paid for by the employer, so there is no financial burden on the employee. Also, this is not a promotion of Lisa, or her employer to collect your resume, it is solely intended to help each of you do the best preparation for yourself, when seeking your next job.

I look forward to seeing you all there.

By James Polando, PE, CPD, V.P. Technical

KIRSCHNER ASSOCIATES, INC.

8 Abbey Lane, PO Box 312
Middleboro, MA 02346-0312
Tel: 800-752-1588 Fax: 508-947-0850
www.kirschnerassociates.com

PATTERSON-KELLEY
AMERIDEX PHX • WENDLAND TANK
RITE BOILERS • NATCO HEATERS
SECURITY CHIMNEYS

Call your fellow ASPE member for Symmons product assistance.
Jim Harrison, John Carter, John Kennedy, Dan O'Brien, Sean Roberts



Symmons Industries, Inc., 31 Brooks Drive, Braintree, MA 02184-3804
800-SYMMONS or (781) 848-2250 Fax: 800-961-9621 or (781) 664-5211
www.symmons.com



Patrick J. Haney

Represented by:
WP Haney Co.
51 Norfolk Ave.
South Easton, MA 02375
Phone (508) 238-2030
Fax (508) 238-8353
Cell (508) 326-7056



For all of your faucet needs

- Residential
- Institutional
- Commercial
- Healthcare



david gooding inc.

David Gooding, Inc., 173 Spark Street, Brockton, MA 02302
1-800-836-3441 or (508) 894-2000 / Fax: 508-894-2005 / www.goodingd.com

PLUMBING MUSEUM COMES TO WATERTOWN, MASS.

*The new museum will be located in a building at the
J.C. Cannistraro Company.
The Grand Opening will be schedule soon.
Visit the website at*

www.theplumbingmuseum.org



**MAR COR
PURIFICATION**

A Cantel Medical Company



Fluid Solutions

- Water purification
- pH neutralization
- Engineering Services
- Full 24/7 Service

Design, Engineering, Equipment, Installation, Service & Training

Mar Cor Purification, www.mcpur.com
160 Stedman St. • Lowell, MA 01851 • 978-453-9600

SLOAN VALVE CO. • HALSEY W. TAYLOR CO. • LEONARD VALVE CO.
WATER SAVER • GUARDIAN • GEORGE FISCHER
JUST • ACORN • MIFAB • CHRONOMITE

J.H. POKORNY ASSOCIATES

1502 PROVIDENCE HIGHWAY
NORWOOD, MA 02062
www.jhpokorny.net

TEL (781) 762-2661
FAX (781) 762-5949
info@jhpokorny.net

Alfred Steele Scholarship Deadline Announced

The deadline for applications for the ASPE Alfred Steele Scholarship is January 31, 2009. It is limited to ASPE members and their immediate families. Applicants must be a full-time student in college, university, or technical school; have maintained a minimum overall GPA of 3.0 on a 4.0 scale, or its equivalent; plan to attend a college, university, or technical school on a full-time basis as of the fall or summer semester of 2009; and be enrolled in a school or program of engineering. Or, applicants can be a high school student who graduates as of June 2009; has maintained a minimum overall GPA of 3.0 on a 4.0 scale, or its equivalent; has been officially accepted by and plans to matriculate into a college, university, or technical school on a full-time basis; and be enrolled in a school or program of engineering. Download forms at www.aspe.org and submit upon completion to Stacey A. Kidd at skidd@aspe.org or mail to the address listed on the application.

Office: 781-344-1988
FAX: 781-344-1989

T & S Farrell Pump Sales, Inc.

Representing Weil Pump Co.
Thomas J. Farrell

P.O. Box 459
11 Dale Street
Stoughton, MA 02072

**RDK
ENGINEERS**

Andover, MA
Boston, MA
New Brunswick, NJ

Richard D. Kimball Company, Inc. has specialized for over 100 years in providing high-quality HVAC, Plumbing, Fire Protection, and Electrical design engineering services. Today we deliver MEP/FP and telecommunications design, systems commissioning and building management support services to some of New England's leading businesses and institutions.

Fire Protection Engineers and Designers Plumbing Engineers and Designers Boston, Andover and New Brunswick, NJ

Duties include the survey of existing engineering systems, performing hydraulic calculations, writing specifications, and performing code research on a number of concurrent projects. Candidate will also be coordinating with other engineering disciplines as needed.

A 4-year engineering degree is preferred along with 1-5 years relevant experience designing plumbing and/or fire protection plans and specifications. A solid understanding of hydraulic calculations is needed along with background in AutoCAD Rev 2004 or above. Also requires knowledge of Massachusetts Codes and NFPA Standards. Must possess excellent written and oral communication skills.

We offer a comprehensive benefits package which includes HMO Blue Health Insurance, Dental, 401(k), Profit Sharing, Short-Term and Long-Term Disability Insurance, Tuition Reimbursement, Flextime, Life Insurance, Bonus Opportunities, and more. Interested applicants should apply online at www.rdkengineers.com/careers or mail or fax resume to:

Richard D. Kimball Company, Inc.
Human Resources
200 Brickstone Square, Andover, MA 01810-1488
careers@rdkengineers.com
Phone 978-296-6315 Fax 978-296-6316

The Fire Pump Testing Company

Evaluation, Testing and Certification of Fire Suppression Systems
Fire Pump Testing, Standpipe Testing and Building Commissioning
Hydrant Flow Testing and Water Supply Analysis
Residential and Commercial System Installation and Service
Fire Protection Design and Engineering - System Hydraulic Analysis

Tel: (617) 971-0700
Fax: (617) 524-7171
Cell: (617) 592-4236

11 Varney Street
Boston, MA 02130-4109
Thomas Duross CPD
<http://www.thefirepumptestingcompany.com>
Email: tom@thefirepumptestingcompany.com
Member: ASPE, NFPA, AFSA, FCCCHR, BBB

ASK THE ARCHITECT ?

Question: Do architects really understand that their (pfp) engineer is not working on 'his project' full time, and that the (pfp) engineer is probably working on 6 to 8 (or more) projects at once? We always try to respond as if 'his project' is the only one we are working on, but it probably doesn't always come across that way. (ps - a simple review of the pfp vs architect's fee split, is a key indicator of this.)

Answer: Sure we do. Many of us also work on several (2-3) to many (4-8) jobs at a time.

A couple of realities you should note however;

- If we are smart project managers in addition to being smart architects, we will have created a work plan with you so you can understand *what* we need and *when*, and you in turn can manage your workload/staff and produce quality docs on time. If we haven't given you clear direction, then we are lousy managers and you should harass us in a professional manner, *i.e. no bruises*, until we do.
- We appreciate and believe that it is important to let us feel that our project is your top priority. It is the professional way to treat us, since we are your clients (whether as a stand alone 'A' or as part of an 'A/E'), and it will likely influence our decision whether to put you on another project or not. After all, we treat *our* clients – the Owner, the same way for the same reason.

Question: Do architects understand that, from a liability standpoint, they are responsible for, and must take an active role in coordinating, our work? The down side of that is, if the engineer is to be sued for errors, that suit probably must also sue the architect.

Answer: We do realize that the architect should actively engage in MEP coordination* for the success of the project and the realization of the architectural design. At least most of us do. If no one on the architectural team has been assigned MEP coordination as a responsibility, ask the PM to appoint someone. If you still get no response it's likely because the architect doesn't have the time or the experience to do so. Please remember that just like engineers we come in all flavors - senior/novice, experienced/inexperienced, those who wear black/those who wear white, smart/not so smart. Not all of us are adept at reading your drawings and realizing the architectural implications. Much of your work is diagrammatic and NTS. If you are working with inexperienced/not so smart architects it is in your best interest to 'teach' them as you go along, no matter how pig headed they are. Besides, even when working with experienced architects it is still your responsibility to point out areas of conflict due to space limitations (ceilings, shafts, partition thicknesses, tolerances, replacement access, etc.) or any other issues which will affect the performance of your systems.

And just a wee peak at the flip side of the coin;

Please don't submit engineering docs that are not at the level of completeness we agreed to, or that have not been reviewed by the senior project engineer or that have not been coordinated between the engineering disciplines themselves. If this last instance happens when MEP is the responsibility of a single firm, our contract mandates keelhauling.

Even with active A & E coordination, things slip by, especially in renovation work. Lack of A & E coordination can be potentially lethal to the success of the project and satisfaction of the Owner without the potential escalation to a law suit. To obtain the best coordination of our work, both A & E must actively participate.

*We won't touch on liability and law suits since it would revolve around the nature of the engineer's error and that's what lawyers, who make way more \$ than us, are for and their column is in their newsletter.

Question: What do you see as some of the major 'faults' of engineers, or some of the things that we should work on to be better at? What 'irks' you the most about engineers?

Answer: Sorry, the editor only allows us so much space. Besides if we keep getting good questions like these, you'll continue to find out.

ASPE National News from the Convention

2008 Convention and EPE Was a Huge Success!

Attendance at the 2008 Engineered Plumbing Exposition in Long Beach, California, set a new record for ASPE events, just shy of 6,000 people. ASPE intentionally limits the floor size to ensure ample time for exhibitors and attendees to interact, and exhibitors had nothing but good things to say about those who flooded the floor in Long Beach. Due to the quality of the attendees, 93 percent of exhibitors on the floor signed up for space at the 2010 EPE in Philadelphia. That's 280 exhibitors already signed up, a remarkable number in today's economy. In 2010, ASPE again will concentrate on attracting quality attendees for those fortunate manufacturers who snap up the remaining exhibit space. Look for the Convention and EPE highlights in the December 2008 issue of *Plumbing Systems & Design*. Included will be a recap of the events, photos, award winners, and the new Society board of directors.

ASPE Helps the Less Fortunate in Long Beach

In a time when money is tight and resources are scarce, charitable organizations are hard-pressed to help those in need. That's why, when faced with leftover bottled water from the 2008 Convention, ASPE donated 116 cases to the Long Beach Rescue Mission. "This will go a long way in helping us to serve the poor and hungry here in Long Beach," says Dale Neal, the mission's food service manager.

Articles From: ASPE Pipeline

Delegate Report

I would first like to thank the Boston Chapter Board of Directors for selecting me to represent our Chapter Membership to attend the Long Beach National Convention. I truly enjoy all aspects of these biennial events. Our national Board of Directors has worked extremely hard these past two years to successfully address many issues in a positive way.

Some highlights of note this year (my opinion) were the Business Sessions and how well they were kept in line and focused on the task at hand. The exposition was well attended. Green products, solar products, vacuum sewage systems and siphonic roof drainage were some of the more prominent products for me. As a delegate, your days are busy with meetings, product show and seminars. The evenings are filled with less formal convention planned events and having fun with friends.

One of the seminars that I attended was Solar Water Heating. Josh Plaisted of Kineo Design Group, LLC, presented the seminar to a full room of attendees. He began his discussion relative to residential designs and soon learned that he was in a room full of commercial design seeking Engineers. Josh adapted and provided the group with as much information possible given the time allocation. In general, the designs and equipment available today for us have far exceeded our antique 1970's systems. Solar water heating is a real industry that works even in its simplest form. Designs are high performance/efficient, properly sized and backed up with traditional water heating plants. Terms such as stagnation, overheating, variable storage, controls and freeze protection can all be explained in greater detail by reviewing the seminar presentation pdf's. If interested, please email your request to ptaylor@ber-engineering.com and I will be happy to forward the information.

In closing, I welcome any of the membership that has not had the opportunity to attend a Convention to do so. I always encourage our younger membership to step forward, become involved at the local level and put in a request to become a Boston Chapter Delegate. This event provides so much insight to what ASPE is doing for all of us. I would be happy to share what I know to any questions you may have.

By Paul Taylor, ASPE Boston Chapter Delegate and Historian

K Ross Co.
Manufacturers Agent

Ph: 508.747-4493
Fax: 508.746.6678
www.krossco.com



The Spencer Turbine Company

Manufacturer's of:

- UL-Listed Hermetic Natural Gas Boosters
- Central Vacuum Systems for Housekeeping, Oral, and Surgical Laser Smoke Evacuation

Represented by: **Environmental Air Specialties**
P.O. Box 541 – Grafton, MA 01519
p: 508-839-6157 – f: 508-839-4431
www.easne.com

Maurice Brodeur – Sales/Engineering
Cell: 508-958-6346 – mbrodeur@easne.com

AHA

CONSULTING ENGINEERS

Atlanta • Boston • Washington, DC

AHA Consulting Engineers, Inc. located in Lexington, MA has positions available in the Plumbing Department for Designer and a Project Engineer.

We offer competitive salary, comprehensive medical & dental insurance, life and disability insurance, 401K, tuition reimbursement and flexible hours.

Email your resume to: jobs@aha-engineers.com

AHA Consulting Engineers, Inc.
10 Maguire Road, Suite 121,
Lexington, MA 02421

TOYS FOR TOTS



ASPE – Boston Chapter Collected Again This Year for Toys for Tots.

*YOU MADE A DIFFERENCE FOR A CHILD
THIS HOLIDAY SEASON*

**Thank You to All Who Donated
At the December Meeting to
Toys For Tots.**

Quantum Engineering, Inc.

Nancy K. Bonnetti
Medical Gas Specialist

62 Derby Street, Suite Ten
Hingham, MA 02043
Office: 781-740-8008
Fax: 781-740-8228
nbonnetti@quanteng.com

An authorized representative for:



SLOAN.
SLOAN VALVE COMPANY

Represented to ASPE by:

J.H. Pokorny Associates
phone: 781-762-2661

web: www.jhpokorny.net • e-mail: info@jhpokorny.net

The Walter F. MORRIS Company
Serving you since '22

77 Green St. Foxboro, Ma
Ph: 1-800-888-1922
Fax: 1-800-888-1942
www.walterfmorris.com

Boch Aqua-Pure
BENEKE LUX
NTI BOSCH
WATCO Woodford

Acid Waste – Corzan
Sched 40 & 80
WarmRite Radiant
Municipal Systems

PRACTICAL APPLICATIONS

Industrial Process Water and Wastewater Solutions

PACKAGED pH SKIDS MWRA Compliance/Permits
OPERATION & MAINTENANCE PACKAGED GREYWATER SKIDS
BIODECONTAMINATION SYSTEMS DEP WWO TRAINING

Practical Applications, Inc. 12 Channel St. Boston, MA
Tel: 617.423.5639 www.pai-online.com

cubellis

Plumbing & Fire Protection Designer
Designer with 4-8yrs experience specializing in plumbing systems on Residential, Institutional, retail, and corporate projects.

Responsibilities:
Plumbing design engineer on multiple projects from schematic through construction phases. Complete designs with little supervision
Coordinate project work between design trades. Field observation and documentation skills necessary.

Qualifications/Experience:
Strong communication skills, ability to work in a fast-paced environment with multiple deadlines. CDP, CET a plus
Proficiency in Microsoft Office, Outlook and AutoCAD, Hydraulic Calculation Preparation experience is preferred.

We offer competitive salary, benefits, 401K, tuition reimbursement, profit sharing and commission opportunities, and much more.

Contact:
Alicia Calascibetta
Sr. Corporate Recruiter
recruiter@cubellis.com

www.cubellis.com
281 Summer Street
Boston, MA 02210
Fax#: 617.830.0608



*Boston Chapter Member
Bob Higgins and His Wife Trish
Gave Birth to their
Second Daughter*

Kaylie Samantha Higgins

*On Tuesday December 9, 2008
She Weighed 8 lbs, 13.5 oz.*

And the family is doing well.

Dale L. Powell
Regional Manager



Copper Development Association Inc.

P.O. Box 6687
Harrisburg, PA 17112-0687
Tel: (717) 533-0353
Fax: (717) 533-1688
dpowell@cda.copper.org
www.copper.org

CDA is a not-for-profit trade association that serves as the market development and engineering services arm of the copper and brass industry in the United States. CDA is your source for information related to copper and copper alloys.

**Halsey Taylor HVR Series
Vandal-Resistant Water Coolers**

- Stainless steel construction
- U.L. listed for indoor and outdoor service
- Vandal-resistant features
- Can be installed to meet adult or child ADA
- Meets NSF/ANSI 61



 **Halsey Taylor**
Satisfying Thirsts Since 1912
630.574.3500

ADA NSF/ANSI 61

halseytaylor.com

603-644-5554
Fax: 644-3338
800-542-5554

sales@towerhillsales.com
www.towerhillsales.com



P.O. Box 457
320 Rockingham Road, Unit 4
Auburn, New Hampshire 03032

Tower Hill
Sales Associates, Inc.

There is More Than One Good Reason to Spec T&S.



Extensive Product Line —

No matter your industry or application, our extensive range of products and services can meet your needs.



T&S plumbing products represented in Boston by:
Specification Sales - 781-396-0842



RELIABILITY BUILT IN™
www.tbross.com • 1-800-476-4103

FREE DINNER AT NEXT ASPE MEETING

Be one of the first two people
to email the
answers to the following questions to:
richp@jhpokorny.net

And get a FREE DINNER at the
January Meeting

1. How many people attended the
National Convention in Long Beach, CA?
2. How many members does the Boston
Chapter of ASPE currently have?



Guardian

EMERGENCY EYEWASH & SHOWER TECHNOLOGY

J.H. Pokorny Associates
1502 Providence Highway
Norwood, MA 02062
781 762 2661 TELEPHONE
781 762 5949 FACSIMILE

Guardian Equipment
1140 N North Branch St
Chicago, IL 60642
312 447 8100 TELEPHONE
312 447 8101 FACSIMILE

New England Combustion Products, Inc.



Bob Handschiegl — cell 781 760 1884
bhandschiegl@necombustion.com
Office 781 337 8888 fax 781 337 8848



Index of Paid Advertisers

Copper Development Association	8	K Ross Co.	7	Symmons	3
David Gooding, Inc.	3	Kirschner Associates, Inc.	3	T & S Brass / Spec Sales	9
Emerson Swan	10	Leonard Valve	10	T & S Farrell	4
Environmental Air Specialties	7	Mar Cor Purification	4	Tower Hill Sales Associates, Inc.	9
Fire Pump Testing Company	4	Milwaukee Valve	10	W.P. Haney / Watts	3
Gourley	10	New England Combustion Products	9	Walter F. Morris Company	8
Guardian Equipment	9	Practical Applications	8		
Halsey Taylor	8	Quantum Engineering	7		
J. H. Pokorny Associates	4	Sloan Valve Company	7		



From:

**A.S.P.E.
P.O. Box 111
East Walpole, MA 02032**

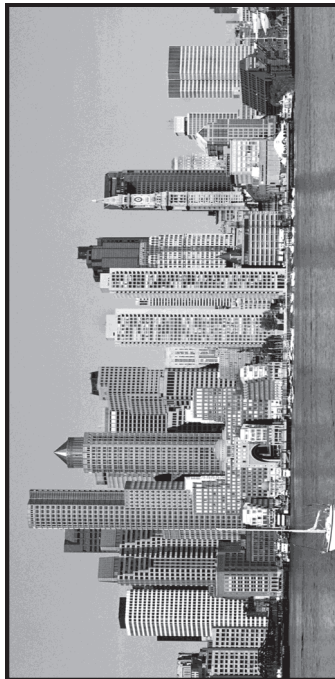

Boston Chapter - AMERICAN SOCIETY OF PLUMBING ENGINEERS

**Next
Event**

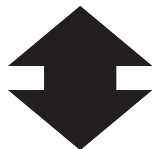

**Tuesday
13th
January**

Send to:

FIRST CLASS MAIL

Joe Myers
Regional Manager
603-223-0107 – Direct
603-223-0108 – Direct Fax
603-496-9031 – Cell Phone
jmyers@milwaukeevalve.com

Milwaukee Valve Company
16550 West Stratton Drive
New Berlin, WI 53151
262-432-2800 – Phone
262-432-2701 – Fax
www.milwaukeevalve.com



Leonard Valve Company
1360 Elmwood Avenue
Cranston, RI 02910
PH (800) 222-1208
Fax (401-941-5310
www.leonardvalve.com

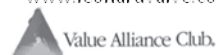

J.H. Pokorny Associates

JH Pokorny Associates
1502 Providence Hwy
Norwood, MA 02062
Ph (781) 762-2661
Fax (781) 762-5949
www.jhpokorny.net

Leonard... "The Right Mix" for tempering your
domestic hot water system

Emerson-Swan

A Manufacturer's Representative

300 Pond Street
Randolph, MA 02368
(800) 346-9215

www.emersonswan.com

Taco ~ SuperStor ~ Elkay ~ A.O. Smith

GOURLYCO

HOT WATER BY DESIGN

80 FELTON STREET, WALTHAM, MA 02453

Phone: 781-894-9500 Fax: 781-894-2301

Website: www.gourleyco.com



Gas Water Heating Boilers
Hydronic Heating Boilers
Gas Fired Booster Heaters
Commercial Pool and Spa Heaters



Tank-type Water Heaters
Gas and Electric
Residential and Commercial



Semi-Instantaneous &
Factory Packaged
Water Heaters



Ultra High Efficiency
Stainless Steel Boilers